

SPECIFICATION
MATERIAL
 Insulator: Thermail Plastic UL94V-0
 Contacts: Copper Alloy
 Shell: Steel
 Rivet, Boardlock: Copper Alloy
CONTACT PLATING
 Underplate: 50u" Nickel
 Contact Area: 1u"~30u" Selective Gold
 Solder Tails Area: 100u" Tin/Lead(Brighten Tin)or
 100u" Tin/Lead Free(Brighten Tin/Matte Tin)
ELECTRICAL
 Operation Voltage: 250 VAC Max.
 Current Rating: 3 Amps Max.
 Contact Resistance: 15 mohms Max.
 Insulation Resistance: 3000 Mohms Min. @ 500 VDC
 Dielectric Withstanding Voltage: 1000 VAC / minute
 Operating Temperature: -55°C to +105°C
 PART NO.

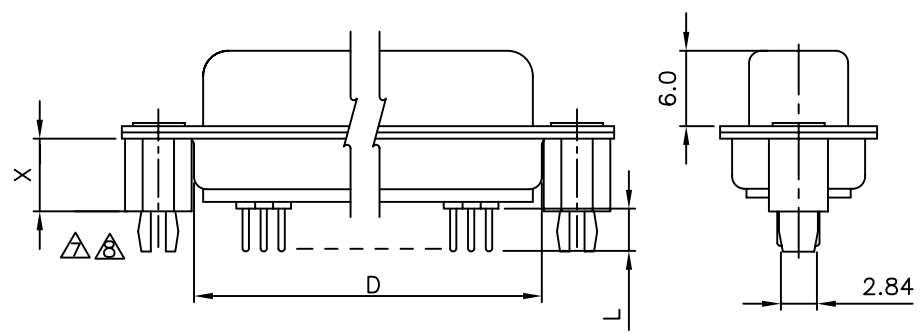

DD-SxxSZxxM3xxx-xx

39	3.9mm
31	3.15mm
70	7.0±0.5mm
21	2.1mm

DIP TYPE DIM. FOR "L":

58	5.8mm
50	5.0mm
87	8.7mm
100	10.0mm
80	8.0mm
67	6.7mm

BOARDLOCK OPTION DIM. FOR "X":

parts no.	DIM. a	DIM. b	inner thread
100	5.0	10.0	4#40
118	4.8	11.8	4#40
108	4.8	10.8	4#40
120	5.8	12.0	4#40

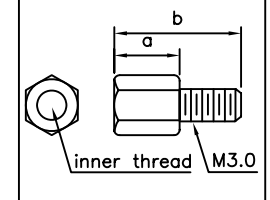

SCREW DIMENSION TABLE

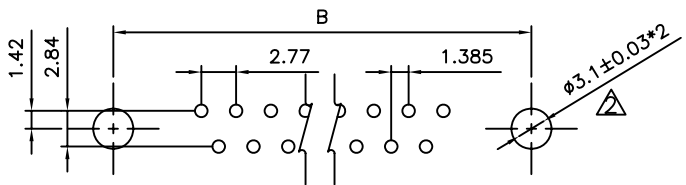

RECOMMENDED P.C.B LAYOUT (TOP VIEW)
 TOLERANCES: ±0.05mm

POSITION	A	B	C	D
DD-SxxSZxxM3xxx-09	16.30	25.00	30.8	19.2
DD-SxxSZxxM3xxx-15	24.60	33.30	39.2	27.7
DD-SxxSZxxM3xxx-19	30.00	38.86	44.8	32.8
DD-SxxSZxxM3xxx-23	35.30	44.30	50.3	38.3
DD-SxxSZxxM3xxx-25	38.30	47.10	53.1	41.1
DD-SxxSZxxM3xxx-37	54.80	63.50	69.4	57.3



PART NO. DD-SxxSZxxM3xxx-xx

DWG NO. DD-SxxSZxxM3xxx-xx

CHECKED BY CY

TOLERANCES ARE

DESCRIP TION: D-SUB PCB STRAIGHT

FILE NO.

DRAWING BY

.X ± 0.2
.XX ±
.XXX ±
AWG

AREA	REVISIONS	HK	DATE
------	-----------	----	------

焯倫股份有限公司

UNIT / mm

SCALE 1:1

PROJECTION