

PLUG 匹配示意图

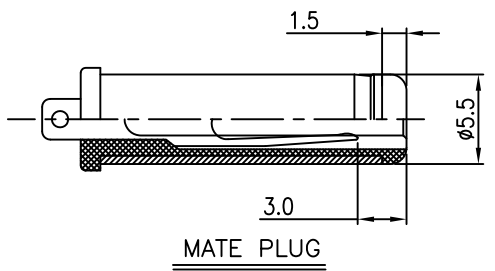

MATE PLUG

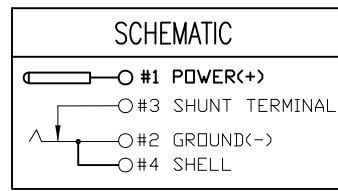

SPECIFICATIONS:

1. ELECTRICAL CHARACTERISTICS:
 - 1-1. RATING:
 - 1-2. CONTACT RESISTANCE: 30mΩ MAX.(INITIAL)
 - 1-3. DIELECTRIC WITHSTANDING VOLTAGE: 500V AC FOR ONE MINUTE
 - 1-4. INSULATION RESISTANCE: 100MΩ MIN. MEASURED BY 500V DC
2. MECHANICAL CHARACTERISTICS:
 - 2-1. INSERTION FORCE : 0.3~3.0 KGF
 - 2-2. WITHDRAWAL FORCE : 0.3~3.0 KGF
3. LIFE TEST: 5,000 CYCLES MIN.
4. FOR REFLOW SOLDERING LEAD-FREE PROCESS.

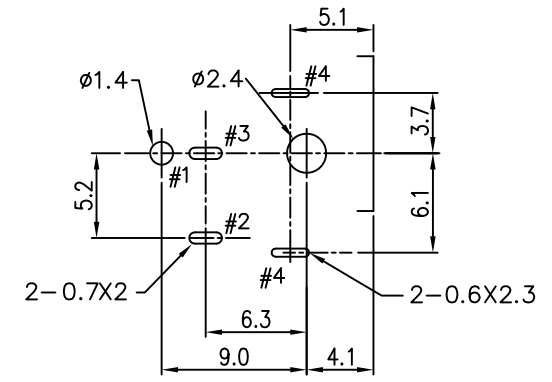

T:1.6 Dimensions of PC board holes
Tolerance : ±0.05(Printed-top view)

7	HOUSING	1	PA9T		UL-94V0(BLACK)
6	TERMINAL	1	SUS301	t=0.30±0.05	N/A
5	GROUNDING SPRING	1	SUS301	t=0.10±0.05	N/A
4	SHIELDING	1	C2680	t=0.20±0.05	Ni(50u"min) PLATED
3	CURVE PIECE	1	C2680	t=0.30±0.05	Sn(100u"min) PLATED
2	SPRING PIECE	1	C5191	t=0.30±0.05	Sn(100u"min) PLATED
1	PIN	1	H59(COPPER ALLOY)		Ni(50u"min) PLATED
LTR	PART NAME	QTY	MATERIAL		REMARK

UNLESS OTHERWISE SPECIFIED, TOLERANCE ON DECIMAL:±0.3

RoHS Compliant

TOLERANCES ARE



煜倫股份有限公司

www.morethanall.com

DRAWING BY CY

CHECKED BY GENIUS

UNIT / mm SCALE 1 : 1

DATE

SIZE A4

X, ±
.X ±
.XX ±
.XXX ±
ANG ±

P PROJECTION

照片框

ORDER INFORMATION

DCJ-R40A9M-25-LF

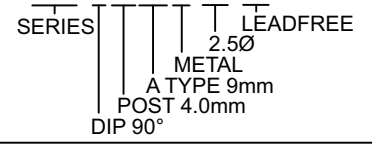

DESCRIPTION: DC POWER JACK