

T:1.6 Dimensions of PC board holes
Tolerance : ±0.1(Printed-top view)

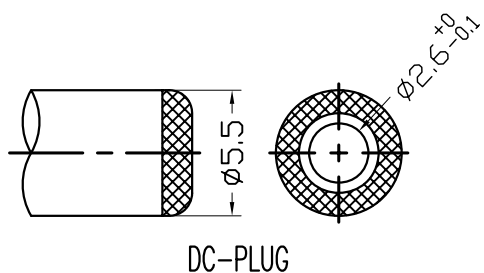

DC-PLUG

CAT. NO.	PIN	SCHEMATIC
DCJ-DPE13-25	φ2.5	

LTR	PART NAME	QTY	MATERIAL	REMARK
6	COVER	1	PBT 4815	UL-94V0(BLACK)
5	AXIS SUPPORT	1	C2680	MB:Cu Sn PLATED
4	PIN	1	C2680	MB:Cu Ni PLATED
3	SPRING	1	Mn steel A2	MB:Cu Sn PLATED
2	FLAT PIECE	1	C2680	MB:Cu Sn PLATED
1	HOUSING	1	PBT 4815	UL-94V0(BLACK)

UNLESS OTHERWISE SPECIFIED, TOLERANCE ON DECIMAL:±0.3

RoHS Compliant

TOLERANCES ARE

MORETHANALL
PCB CONNECTORS
Cable ASSEMBLIES
煜倫股份有限公司

DRAWING BY CY

CHECKED BY GENIUS

UNIT / mm SCALE 1 : 1

DATE

SIZE A4

X, ±
.X ±
.XX ±
.XXX ±
ANG ±

P PROJECTION

照片框

ORDER INFORMATION

DCJ-DPE13-25-LF
SERIES
LEADFREE
2.5φ
HIGH 13.5mm
DIP 180° EAR PANEL

DESCRIPTION: DC POWER JACK

www.morethanall.com