

### Material & Finish

SHELL:  
 ABS, BLACK  
 INSULATOR  
 PBT, BLACK  
 PIN CONTACT:  
 PHOSPHOR BRONZE,  
 GOLD FLASH  
 SCREW:  
 STEEL, NICKEL PLATED

CURRENT RATING:  
 5 Amp  
 DIELECTRIC STRENGTH:  
 1000V for one minute  
 INSULATOR RESISTANCE:  
 1000MΩ Min. (at 500V DC)  
 TEMPERATURE:  
 -55°C to +105°C

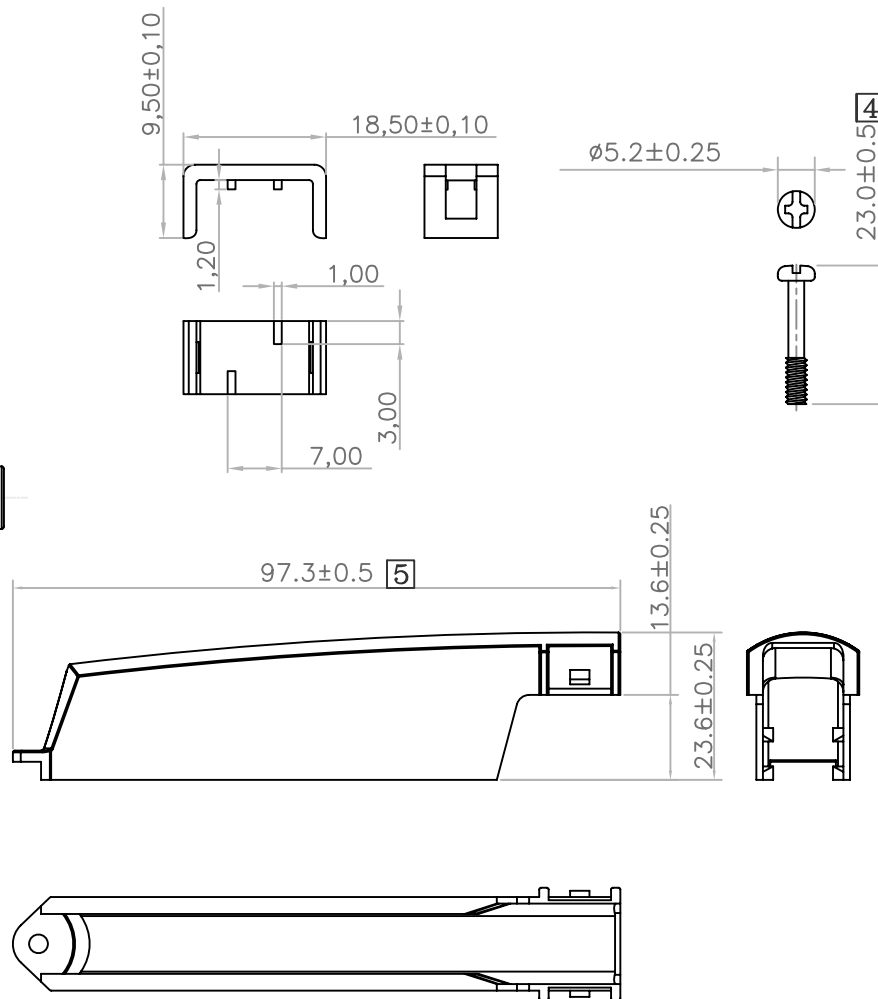
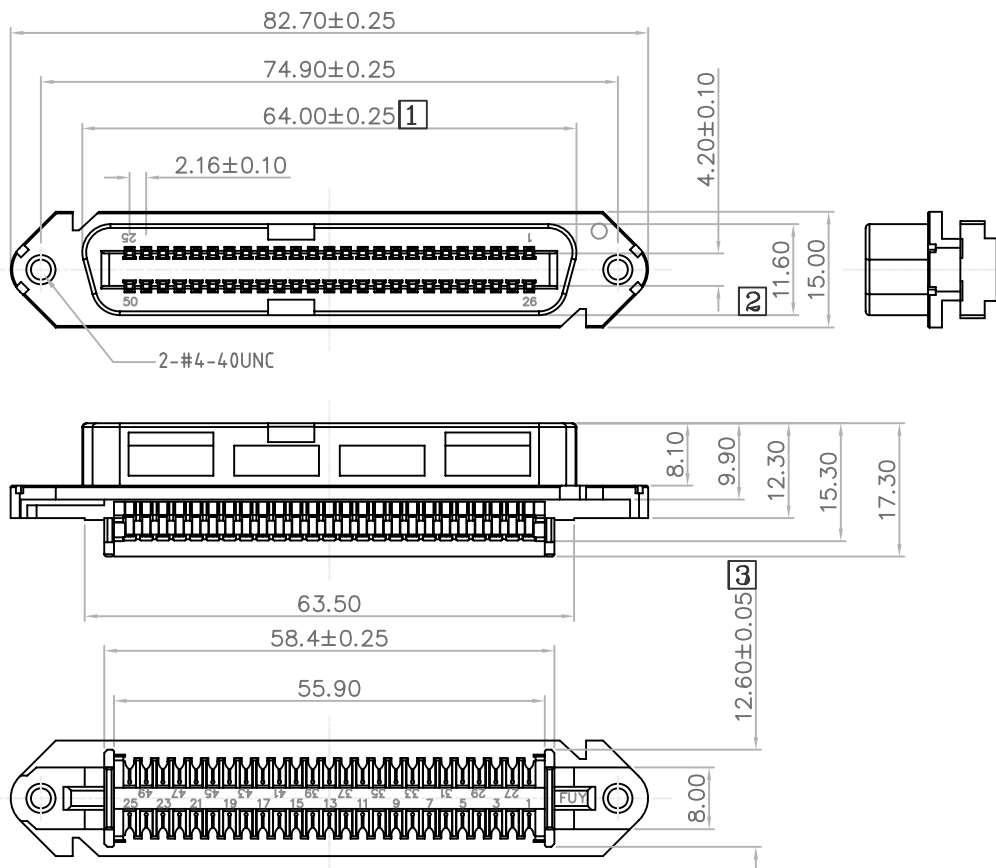

RoHS Compliant

TOLERANCES ARE

**MORETHANALL**  
 PCB CONNECTORS  
 Cable ASSEMBLIES

DRAWING BY CY

X ± 0.30

CHECKED BY GENIUS

.X ± 0.25

UNIT / mm

SCALE 1 : 1

.XX ± 0.15

DATE

.XXX ±

ANG ± 3°

SIZE A4

P PROJECTION

照片框

ORDER INFORMATION

CTL-SK-50-LF  
 SERIES | LEADFREE  
 | 50 WAY  
 | BLACK  
 | FEMALE

煜倫股份有限公司

www.morethanall.com

DESCRIPTION: CENTRONIC I. D. C. TYPE FEMALE 50 PIN RIGHT ANGLE COVER ALL PLASTIC