

• **MATERIALS:(Rohs Compliant)**

Housing & Cover: Thermoplastic P.B.T UL94V-0
 Contacts: Phosph Bronze Gold Selective Plated
 Front Shell: Steel,Nickel Plated Over Copper
 Back Shell: Steel,Nickel Plated Over Copper
 Screws: Steel,Nickel Plated Over Copper

• **ELECTRICAL CHARACTERISTICS:**

Contact Current Rating: 5 Amp
 Dielectric Withstanding Voltage: 500V AC
 Insulation Resistance: >1000M Ω/Min
 Contact Resistance: 30mΩ/Max
 Operation Temperature: -55°~+85°c

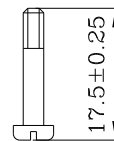
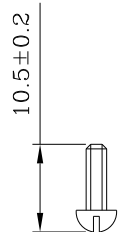
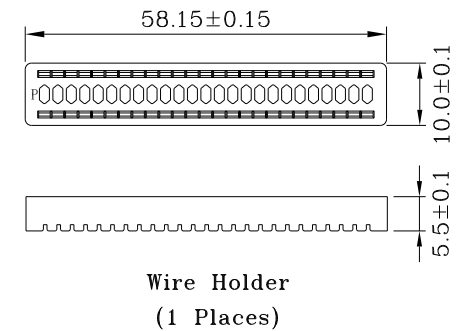
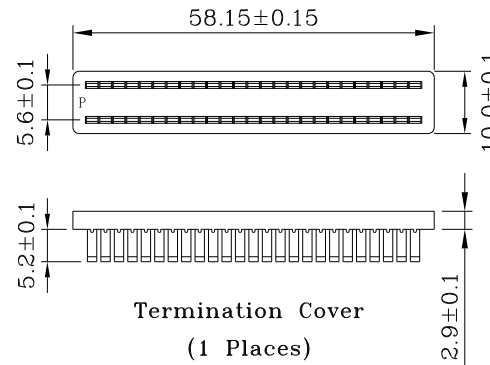
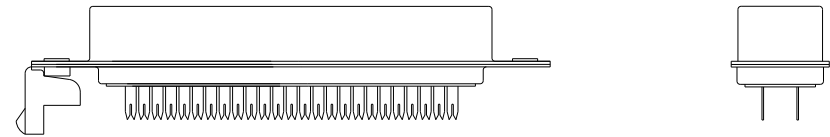
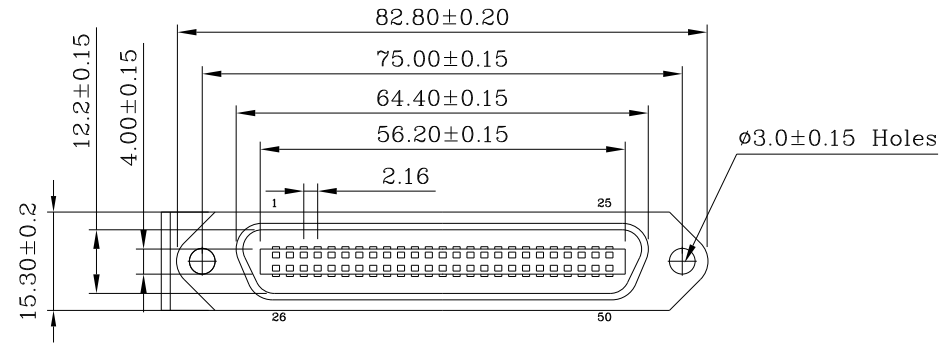

RoHS Compliant

TOLERANCES ARE

MORETHANALL
 PCB CONNECTORS
 Cable ASSEMBLIES

DRAWING BY CY

CHECKED BY GENIUS

UNIT / mm

SCALE 1 : 1

DATE

SIZE A4

X. ±
 .X ±
 .XX ±
 .XXX ±
 ANG ±

PJECTION

照片框

ORDER INFORMATION

CTL-PM-50-LF
 SERIES | LEADFREE
 | 50 WAY
 | METAL COVER
 MALE

煜倫股份有限公司

www.morethanall.com

DESCRIPTION: 2.16(.085') Ribbon Series Plug Cable Connector I.D.C Type (With Metal Hood Angle Exit)