

#### ELECTRICAL PERFORMANCE:

1. RATING: DC3V, 120mA.
2. INTER-CONTACT RESISTANCE: 100m OHM MAX  
AT BOTH THE POSITIVE AND NEGATIVE TERMINALS  
WHEN MEASURED BETWEEN THE TERMINALS OF THE  
CR2032 AT 1KHz WITH LOW DRAINAGE(100mA MAX.)
3. INSULATION RESISTANCE: 100M OHM MIN. WITH DC  
500V APPLIED BETWEEN THE POSITIVE AND NEGATIVE  
TERMINALS.
4. VOLTAGE DURABILITY: NO DEGRADATION WITH DC  
500V APPLIED FOR ONE MINUTE BETWEEN THE POSITIVE  
AND NEGATIVE TERMINALS.

#### MECHANICAL PERFORMANCE:

1. BATTERY INSERTION FORCE: 0.3KG-1.0KG FOR THE  
INITIAL CR2032 BATTERY INSERTION.
2. SPRING PRESSURE: 50G MIN. INITIAL CONTACT FORCE  
AT POSITIVE AND NEGATIVE TERMINALS.
3. TERMINAL STRENGTH: ELECTRICAL AND MECHANICAL  
PERFORMANCE SPECIFICATIONS SHOULD STILL BE  
SATISFIED. WITHOUT TERMINAL CRACKING OR  
EXCESSIVE PLAY. WITH A STATIC LOAD OF 1KG APPLIED  
TO THE TERMINALS IN ANY DIRECTION. HOWEVER, THE  
TERMINAL MAY BEND.

#### MOUNTING DETAIL

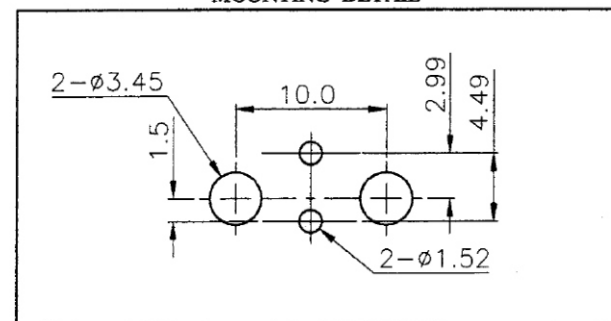

3.	NEGATIVE CONTACT	1	BRASS	TIN	
2.	POSITIVE CONTACT	1	PHOSPHOR BRONZE	TIN	
1.	HOUSING	1	P.B.T.		UL94V-0
P/N	PART NAME	Q'TY	MATERIAL	PLATING	REMARKS

#### RoHS Compliant

TOLERANCES ARE

**MORETHANALL**  
PCB CONNECTORS  
Cable ASSEMBLIES

煜倫股份有限公司

www.morethanall.com

DRAWING BY CY

CHECKED BY GENIUS

UNIT / mm

SCALE 1 : 1

DATE

SIZE A4

X, ±  
.X ±  
.XX ±  
.XXX ±  
ANG ±

PPOJECTION

照片框

#### ORDER INFORMATION

BTH-UP-20-LF  
SERIES T LEADFREE  
CR 2032  
POST  
U TYPE

DESCRIPTION: