

LOCK WASHER

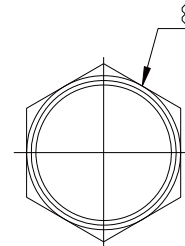

1/2-28UNEF-2B
CLAMP NUT

RECOMMENDED MOUNTING HOLE
MAXIMUM PANEL THICKNESS:5.5MM

NO	DESCRIPTION	MATERIAL	FINISH	QTY
8	NUT	BRASS	NICKEL	1
7	WASHER	STEEL	NICKEL	1
6	SOLDER TAIL	BRASS WIRE	TIN LEAD	1
5	MOUNTING POST	BRONZE	TIN LEAD	1
4	INSULATOR	PE-606	NONE	1
3	HOUSING	PBT	WHITE	1
2	BODY	ZINC ALLOY	NICKEL	1
1	CENTER CONTACT	BRONZE	GOLD	1

RoHS Compliant

TOLERANCES ARE

MORETHANALL
PCB CONNECTORS
Cable ASSEMBLIES

煜倫股份有限公司

www.morethanall.com

DRAWING BY CY

CHECKED BY GENIUS

UNIT/mm SCALE 1:1

DATE

SIZE A4

X.±
.X±
.XX±
.XXX±
ANG±

PROJECTION

照片框

ORDER INFORMATION

BNC-JD15WWH-50-LF
SERIES | JACK | 50 OHM | LEADFREE
WHITE
WASHER+NUT
WIDE 15.8mm
DIP 180°

DESCRIPTION: 50Ω BNC VERTICAL PCB/PANEL MOUNT JACK