

RECOMMENDED PCB LAYOUT  
GENERAL TOLERANCE ±0.05

NOTES:

1. MATERIAL:
  - 1.1 HOUSING: THERMOPLASTIC, HIGH TEMP., UL94V-0; COLOR:BLACK.
  - 1.2 CONTACT: COPPER ALLOY.
  - 1.3 NUT: STEEL.
2. TERMINAL FINISH:
  - 50~100u" NICKEL UNDERPLATING OVER ALL,
  - 5u" GOLD CONTACT AREA, GOLD FLASH ON SOLDER AREA.
3. REFLOW SOLDER CAPABLE TO 260°C PER
4. WAVE SOLDER CAPABLE TO 260°C PER

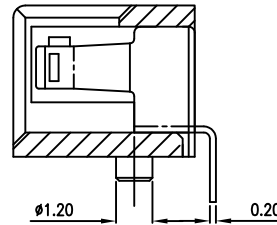
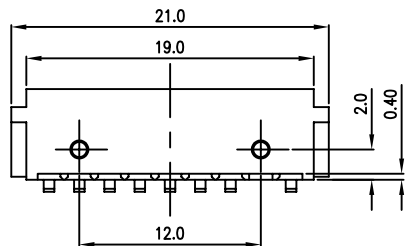
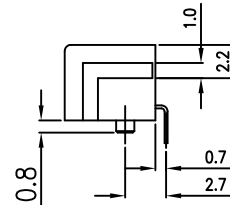
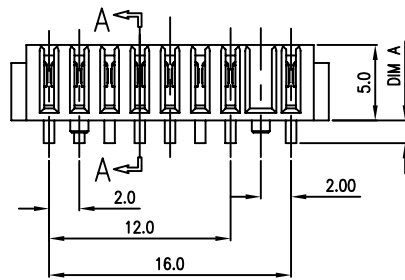

SECTION A-A  
(SCALE 2:1)

RoHS Compliant

TOLERANCES ARE



煜倫股份有限公司

www.morethanall.com

|                   |              |   |
|-------------------|--------------|---|
| DRAWING BY CY     |              | X. ± 0.50<br>.X ± 0.25<br>.XX ± 0.15<br>.XXX ± 0.10<br>ANG ± 2° |
| CHECKED BY GENIUS |              |   |
| UNIT / mm         | SCALE 1 : 1  |   |
| DATE              |              |   |
| SIZE A4           | P PROJECTION |   |

照片框

ORDER INFORMATION

BCC20-SR50P1-08R2-LF

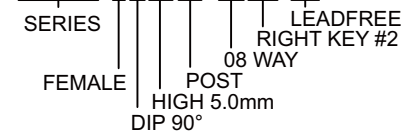

DESCRIPTION: