

**MATERIAL**  
 INSULATOR: GLASS-REINFORCED THERMOPLASTIC.  
 CONTACT: COPPER ALLOY.  
 PLATING: MATING AREA - SELECTED GOLD OVER NICKEL.  
 SOLDER AREA - TIN/LEAD 100u" OVER NICKEL 50u" MIN.

**ELECTRICAL**  
 VOLTAGE RATING: 250 VAC RMS.  
 CURRENT RATING: 1 AMP.  
 DIELECTRICAL WITHSTANDING VOLTAGE: 400 VAC RMS 60 Hz FOR 1 MINUTE.  
 INSULATION RESISTANCE: 800 MEGOHMS MIN AT 500 VDC.  
 CONTACT RESISTANCE: 20 MILLIOHMS MAX AT 1 AMP DC.

**MECHANICAL**  
 RETENTION FORCE: 500 GRAMS MIN PER CONTACT.  
 INSERTION FORCE: 120 GRAMS MAX PER CONTACT PER.  
 WITHDRAWAL FORCE: 15 GRAMS MIN PER CONTACT PER.

**ENVIRONMENTAL**  
 TEMPERATURE RANGE: -55°C TO +85°C.

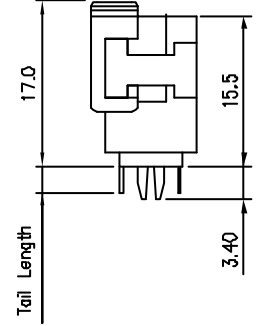
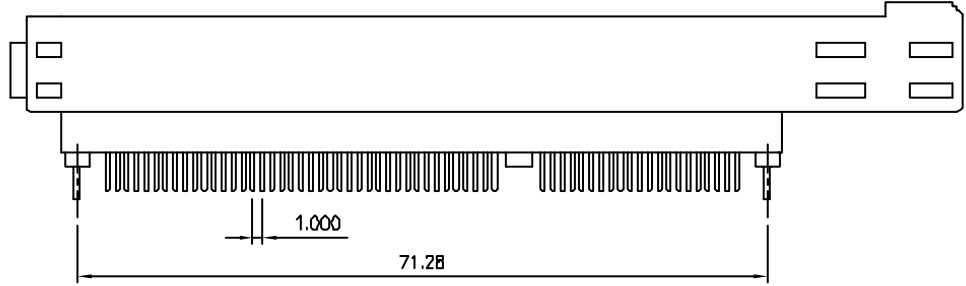
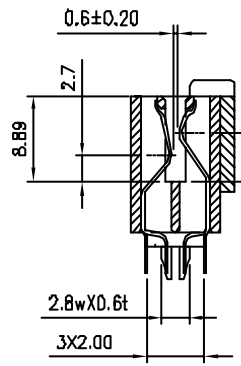

SECTION A-A

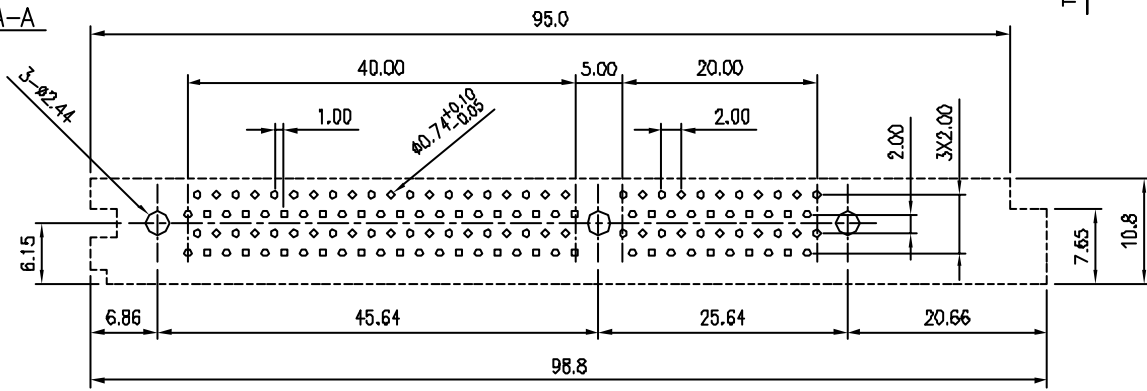

RECOMMENDED PCB LAYOUT

**MORETHANALL**  
 PCB CONNECTORS  
 Cable ASSEMBLIES  
 煜倫股份有限公司  
 www.morethanall.com

<b>RoHS Compliant</b>		TOLERANCES ARE
DRAWING BY CY		X, ±
CHECKED BY GENIUS		.X ± 0.30
UNIT / mm	SCALE 1 : 1	.XX ± 0.20
DATE		.XXX ± 0.10
SIZE A4	PJECTION	ANG ±



**ORDER INFORMATION**

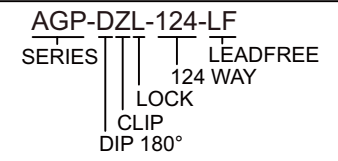

DESCRIPTION: AMM 124P 1.5V WITH CLIP SLOT , A TYPE